

# E25X

## ELECTRIC MINI EXCAVATOR



ELECTRIC POWERTRAIN	
Nominal battery voltage	102 volts
Battery chemistry	Lithium ion
Battery capacity	
Total gross capacity	32.3 kWh
Net usable capacity	25.8 kWh
On-board charger	240V 1 phase
Charging time 0 - 100%	9 hr
Charging time 20 - 80%	5 hr
On-board connector type	NEMA 6-20
Off-board charger #1	240V 1 phase
Charging time 0 - 100%	7.3 hr
Charging time 20 - 80%	4.5 hr
Off-board charger #2	208V 3 phase
Charging time 0 - 100%	2.5 hr
Charging time 20 - 80%	1.5 hr
Off-board charger #3	480V 3 phase
Charging time 0 - 100%	2 hr
Charging time 20 - 80%	1 hr
Run time	4-8 hours depending on application
Motor type	Internal permanent magnet (IPM)
Rated motor power	34 hp (25 kW)
Peak motor power	43 hp (32 kW)
Motor speed	
Eco mode	2000 RPM
Standard mode	2400 RPM
Power mode	2600 RPM

TRACK DRIVE	
Max travel speed	
Turtle	1.6 mph (2.6 kph)
Rabbit	2.5 mph (4.0 kph)
Traction force	4950 lbf (2200 daN)
Gradeability	30° (60%)
Ground pressure	5 psi (0.35 kg/cm <sup>2</sup> )

OPERATOR ENVIRONMENT	
Tilttable roll-bar (ROPS/TOPS); Optional canopy (FOPS Level 1); Vinyl seat; Height adjustable arm rests; Controls cut-out lever (safety lever); 2 in (51 mm) Seat belt; Bottle/cup holder; Keyed locks common w/ starting key; Document glove box; Slewing locking lever; Auxiliary electrical socket; Control Panel.	
Controls:	Travel Levers; Travel foot pedals; EH joysticks for boom, arm, bucket, and swing; Emergency stop button; Boom swing roller switch; Horn; Auxiliary hydraulics roller; Ignition switch; Blade control lever.
Display includes:	Hydraulic Oil Temp; Machine hours; Time; Warning indicators; Message area; Function indicators; Work modes; Motor speed; Battery level indicator; Fast drive indicator; Equipment selection; Control mode.

OPERATING WEIGHT	
Standard arm & canopy	5159 lb (2340 kg)
Standard arm & cab	5445 lb (2470 kg)
Long arm & canopy	5180 lb (2350 kg)
Long arm & cab	5467 lb (2480 kg)
Mechanical quick coupler	68 lb (31 kg)

NOTE: Weight includes bucket, 165 lb operator, fluids.

SERVICE CAPACITIES	
Hydraulic tank:	
Refill capacity	3.8 gal (14.5 L)
Total system	7.4 gal (28 L)

HYDRAULICS	
Load sensing w/ "Flow Sharing" control valve	
Pump type	Load sense variable pump
Pump displacement	1.1 in <sup>3</sup> (18 cc)
Total flow rate	13.7 gpm (52 L/min)
Operating pressure	3045 psi (210 bar)
Auxiliary flow:	
Aux 1 - 1 or 2-way circuit:	
Max flow	13.2 gpm (50 L/min)
Max pressure	3,190 psi (220 bar)
Aux 2 - 2-way circuit:	
Max flow	13.2 gpm (50 L/min)
Max pressure	3,190 psi (220 bar)
Swing motor:	Hydraulic drive units w/ axial pistons
Travel motor:	Travel motor: Variable displacement hydraulic orbital gear motors, Auto-Shift 2-speed transmission, and hydraulic released parking brake

OTHER SPECIFICATIONS	
Swing speed	10.5 RPM
Boom:	
Swing	81° left / 58° right
Length	6 ft 3 in (1.9 m)
Arm:	
Standard length	4 ft 1 in (1.25 m)
Long arm length	4 ft 9 in (1.45 m)



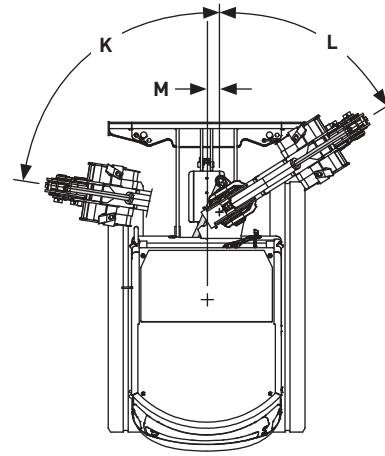
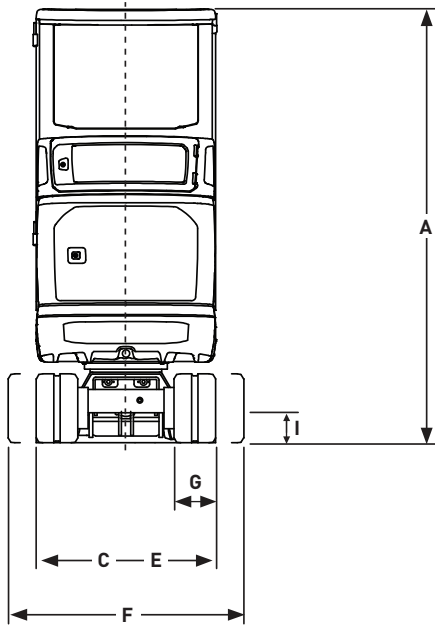

#### DIMENSIONS

<b>A</b>	Overall height	7 ft 10 in (2395 mm)
<b>B</b>	Overall transport length	13 ft 7 in (4145 mm)
<b>C</b>	Width of upper structure	3 ft 3 in (990 mm)
<b>D</b>	Track overall length	5 ft 5 in (1655 mm)
	Track overall width:	
<b>E</b>	Tracks Retracted	3 ft 3 in (990 mm)
<b>F</b>	Tracks Extended	4 ft 3 in (1300 mm)
<b>G</b>	Track shoe width	9 in (230 mm)
<b>H</b>	Center to center - idler to sprocket	4 ft 2 in (1280 mm)
<b>I</b>	Minimum ground clearance	6 in (165 mm)
<b>J</b>	Tail swing radius:	
	Standard counterweight	3 ft 1 in (950 mm)
	Tail swing overhang:	
	Tracks retracted	1 ft 6 in (455 mm)
	Tracks extended	12 in (300 mm)
<b>K</b>	Boom swing left	81°
<b>L</b>	Boom swing right	58°
<b>M</b>	Boom swing offset	3 in (80 mm)

#### BLADE SPECS

<b>N</b>	Backfill blade height	10 in (245 mm)
<b>O</b>	Backfill blade rise above ground	11 in (280 mm)
<b>P</b>	Backfill blade dig depth	11 in (275 mm)
	Backfill blade width	3 ft 3 in - 4 ft 3 in (275 mm - 1300 mm)

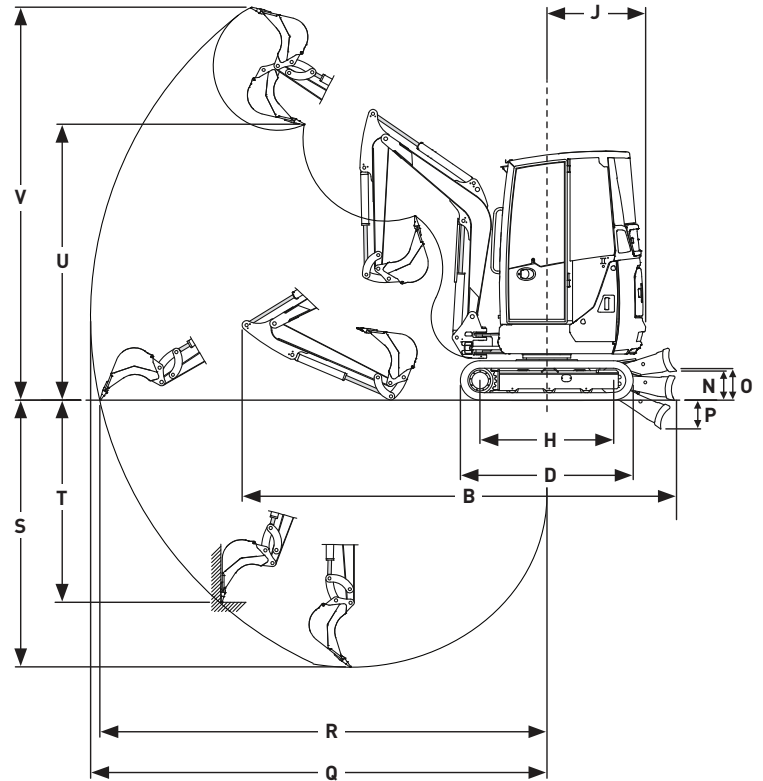

#### PERFORMANCE SPECS

	Standard Arm	Long Arm	
<b>Arm Length</b>	<b>4 ft 1 in (1.25 m) Arm</b>	<b>4 ft 9 in (1.45 m) Arm</b>	
<b>Q</b>	Maximum dig radius	14 ft 4 in (4380 mm)	15 ft 0 in (4480 mm)
<b>R</b>	Dig radius at groundline	14 ft 1 in (4290 mm)	14 ft 9 in (4490 mm)
<b>S</b>	Maximum dig depth	8 ft 5 in (2560 mm)	9 ft 1 in (2760 mm)
<b>T</b>	Vertical straight wall dig depth	6 ft 5 in (1950 mm)	7 ft 0 in (2140 mm)
<b>U</b>	Dump height	8 ft 8 in (2650 mm)	9 ft 1 in (2760 mm)
<b>V</b>	Overall reach height	12 ft 5 in (3775 mm)	12 ft 9 in (3885 mm)
	Arm digging force - ISO	2248 lbf (1000 daN)	
	Bucket digging force - ISO	3597 lbf (1600 daN)	

Line drawings are for illustrative purpose only and may not be exact representation of unit.

# E25X ELECTRIC MINI EXCAVATOR SPECIFICATIONS

## LIFT CAPACITIES

**6 ft 3 in (1.9 m) Boom, 4 ft 1 in (1.25 m) Arm, Dozer Blade Up** *Machine equipped with cab, rubber tracks, standard counterweight, without bucket or quick coupler.*

Load (Lift Point) Height	Load Radius										Maximum Reach		
	4.9 ft (1.5 m)		6.6 ft (2.0 m)		8.2 ft (2.5 m)		9.8 ft (3.0 m)		11.5 ft (3.5 m)		Reach Ø	Capacity	
	End	Side	End	Side	End	Side	End	Side	End	Side		End	Side
+8.2 ft (2.5 m)							794 lb (360 kg)*	794 lb (360 kg)*			10 ft 8 in (3.25 m)	860 lb (390 kg)*	794 lb (360 kg)
+6.6 ft (2.0 m)							816 lb (370 kg)*	816 lb (370 kg)*	838 lb (380 kg)	706 lb (320 kg)	11 ft 7 in (3.52 m)	816 lb (370 kg)	706 lb (320 kg)
+4.9 ft (1.5 m)					992 lb (450 kg)*	992 lb (450 kg)*	904 lb (410 kg)*	882 lb (400 kg)	816 lb (370 kg)	706 lb (320 kg)	12 ft 1 in (3.68 m)	772 lb (350 kg)	639 lb (290 kg)
+3.3 ft (1.0 m)			1632 lb (740 kg)*	1521 lb (690 kg)	1213 lb (550 kg)*	1103 lb (500 kg)	1014 lb (460 kg)	860 lb (390 kg)	816 lb (370 kg)	684 lb (310 kg)	12 ft 4 in (3.76 m)	728 lb (330 kg)	617 lb (280 kg)
+1.6 ft (0.5 m)			1786 lb (810 kg)	1455 lb (660 kg)	1301 lb (590 kg)	1080 lb (490 kg)	992 lb (450 kg)	838 lb (380 kg)	794 lb (360 kg)	684 lb (310 kg)	12 ft 4 in (3.75 m)	728 lb (330 kg)	617 lb (280 kg)
Groundline	2778 lb (1260 kg)	2183 lb (990 kg)	1742 lb (790 kg)	1433 lb (650 kg)	1257 lb (570 kg)	1058 lb (480 kg)	992 lb (450 kg)	816 lb (370 kg)	794 lb (360 kg)	662 lb (300 kg)	12 ft 0 in (3.66 m)	750 lb (340 kg)	639 lb (290 kg)
-1.6 ft (-0.5 m)	2778 lb (1260 kg)	2183 lb (990 kg)	1742 lb (790 kg)	1411 lb (640 kg)	1257 lb (570 kg)	1036 lb (470 kg)	970 lb (440 kg)	816 lb (370 kg)			11 ft 5 in (3.48 m)	794 lb (360 kg)	684 lb (310 kg)
-3.3 ft (-1.0 m)	2800 lb (1270 kg)	2205 lb (1000 kg)	1742 lb (790 kg)	1411 lb (640 kg)	1257 lb (570 kg)	1036 lb (470 kg)	970 lb (440 kg)	816 lb (370 kg)			10 ft 6 in (3.19 m)	904 lb (410 kg)	750 lb (340 kg)
-4.9 ft (-1.5 m)	2514 lb (1140 kg)*	2227 lb (1010 kg)	1720 lb (780 kg)*	1433 lb (650 kg)	1235 lb (560 kg)*	1058 lb (480 kg)					8 ft 11 in (2.73 m)	1014 lb (460 kg)*	948 lb (430 kg)

**6 ft 3 in (1.9 m) Boom, 4 ft 9 in (1.45 m) Long Arm, Dozer Blade Up** *Machine equipped with cab, rubber tracks, standard counterweight, without bucket or quick coupler.*

Load (Lift Point) Height	Load Radius										Maximum Reach		
	4.9 ft (1.5 m)		6.6 ft (2.0 m)		8.2 ft (2.5 m)		9.8 ft (3.0 m)		11.5 ft (3.5 m)		Reach Ø	Capacity	
	End	Side	End	Side	End	Side	End	Side	End	Side		End	Side
+8.2 ft (2.5 m)							684 lb (310 kg)*	684 lb (310 kg)*			11 ft 5 in (3.49 m)	772 lb (350 kg)*	706 lb (320 kg)
+6.6 ft (2.0 m)							728 lb (330 kg)*	728 lb (330 kg)*	750 lb (340 kg)*	706 lb (320 kg)	12 ft 3 in (3.74 m)	750 lb (340 kg)	639 lb (290 kg)
+4.9 ft (1.5 m)							816 lb (370 kg)*	816 lb (370 kg)*	794 lb (360 kg)*	706 lb (320 kg)	12 ft 9 in (3.89 m)	706 lb (320 kg)	595 lb (270 kg)
+3.3 ft (1.0 m)			1411 lb (640 kg)*	1411 lb (640 kg)*	1103 lb (500 kg)*	1103 lb (500 kg)*	948 lb (430 kg)*	860 lb (390 kg)	816 lb (370 kg)	684 lb (310 kg)	13 ft 0 in (3.97 m)	684 lb (310 kg)	573 lb (260 kg)
+1.6 ft (0.5 m)			1786 lb (810 kg)	1477 lb (670 kg)	1301 lb (590 kg)	1080 lb (490 kg)	992 lb (450 kg)	838 lb (380 kg)	794 lb (360 kg)	684 lb (310 kg)	13 ft 0 in (3.97 m)	662 lb (300 kg)	573 lb (260 kg)
Groundline	2778 lb (1260 kg)	2161 lb (980 kg)	1742 lb (790 kg)	1411 lb (640 kg)	1257 lb (570 kg)	1036 lb (470 kg)	970 lb (440 kg)	816 lb (370 kg)	794 lb (360 kg)	662 lb (300 kg)	12 ft 8 in (3.87 m)	684 lb (310 kg)	573 lb (260 kg)
-1.6 ft (-0.5 m)	2756 lb (1250 kg)	2161 lb (980 kg)	1720 lb (780 kg)	1411 lb (640 kg)	1235 lb (560 kg)	1036 lb (470 kg)	970 lb (440 kg)	816 lb (370 kg)	794 lb (360 kg)	662 lb (300 kg)	12 ft 2 in (3.71 m)	728 lb (330 kg)	617 lb (280 kg)
-3.3 ft (-1.0 m)	2778 lb (1260 kg)	2161 lb (980 kg)	1720 lb (780 kg)	1389 lb (630 kg)	1235 lb (560 kg)	1014 lb (460 kg)	970 lb (440 kg)	794 lb (360 kg)			11 ft 3 in (3.44 m)	816 lb (370 kg)	684 lb (310 kg)
-4.9 ft (-1.5 m)	2800 lb (1270 kg)	2183 lb (990 kg)	1742 lb (790 kg)	1411 lb (640 kg)	1235 lb (560 kg)	1036 lb (470 kg)	970 lb (440 kg)	816 lb (370 kg)			9 ft 11 in (3.03 m)	948 lb (430 kg)*	816 lb (370 kg)

NOTE: Lifting capacity are based on ISO 10567.

Lifting capacity does not exceed 75% of tipping load with the machine on firm, level ground or 87% of full hydraulic capacity. Back of the arm linkage.

\*Indicates load limited by hydraulic capacity.

For lift capacities with additional counterweights please see operators manual.

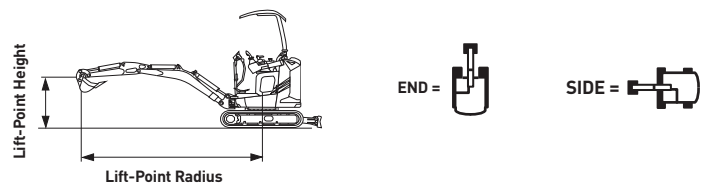

## Standard Equipment

### Electrical

- 12-volt electrical system
- Heavy-duty battery
- Electronic display and controls
- 3 pre-set control modes
- Electronic flow setting for every mode and auxiliary circuits
- On-board battery charger (240 VAC)
- Control pattern mode
- Auxiliary electrical socket

### Hydraulics

- Joysticks with electro-hydraulic proportional controls
- Electro-hydraulic proportional swing control
- 1st Auxiliary (AUX1) circuit with electro-hydraulic proportional control
- Boom lift cylinder and dozer blade cylinder protection
- Helical gear pump
- Bio-degradable hydraulic oil and lubricants
- Hydraulic quick coupler provision

### Track Drive

- Rubber belt tracks
- 2-speed travel with automatic shift down (from 2nd to 1st gear if more traction is required) and Shift Up
- Fully hydrostatic drive system
- Sealed and lubricated track rollers
- Track tensioner hydraulic adjustment with grease

### Operator Environment

- Open ROPS (Level 1)
- Vinyl mechanical suspension seat
- Cloth mechanical suspension seat (cab)
- 2" lap seat belt

### Lighting

- Standard LED working lights (boom)
- Extra LED working lights (roof)

### Upper Structure

- Standard arm: 4 ft 1 in (1.25 m)
- Swing brake disc type, spring applied and hydraulically released
- Standard dozer blade

### Other

- Swing boom – 81° left/58° right
- Standard counterweight
- Extendable undercarriage
- Operator manual
- Document box and tool kit for maintenance
- Travel alarm

### Telematics

- New Holland FleetForce™ Telematics – includes hardware and a 5-year advanced data subscription for 2-way communication

### Warranty

- Base warranty coverage: 2-Year/2,000-Hour Full Machine Limited Warranty
- 3-Year Electric Powertrain Warranty – (includes all electric powertrain system components - battery, motors, inverters, etc.)
- 3-Year/3,000-Hour EV Care Maintenance Program

## Optional Equipment

### Electrical

- Offboard fast-charger

### Hydraulics

- 2nd Auxiliary (AUX2) circuit with electro-hydraulic proportional control
- Attachment case drain return to tank

### Operator Environment

- Enclosed cab includes overhead opening front window, sliding side window, lockable door, heater and defroster, radio/USB player + 2 speakers

### Lighting

- LED beacon

### Other

- Long arm: 4 ft 9 in (1.45 m)
- English, Spanish, or French operator manual

### Attachments

- Mechanical quick coupler
- Hydraulic coupler
- Digging buckets



New Holland Construction  
500 Diller Ave.  
New Holland, PA 17557

Learn more at [www.newholland.com](http://www.newholland.com)

Design, materials and/or specifications are subject to change without notice and without liability therefor. Specifications are applicable to units sold in Canada, the United States, its territories and possessions, and may vary outside these areas.

© 2025 CNH Industrial America LLC. All rights reserved. New Holland is a trademark in the United States and many other countries, owned by or licensed to CNH Industrial N.V., its subsidiaries or affiliates. Any trademarks referred to herein, in association with goods and/or services of companies other than CNH America LLC, are the property of those respective companies.



Safety begins with a thorough understanding of the equipment. Always make sure you and your operators read the Operator's Manual before using the equipment. Pay close attention to all safety and operating decals and never operate machinery without all shields, protective devices and structures in place. This is a one-person machine. Never allow riders in the cab, outside the machine, or in/on any bucket or attachment.

