

ELECTRIC POWERTRAIN

Nominal Battery Voltage	102 Volts
Battery Chemistry	Lithium ion
Battery Capacity	
Total Gross Capacity	32.3 kWh
Net Usable Capacity	25.8 kWh
On-Board Charger	240V 1 Phase
Charging Time 0-100%	9 hr
Charging Time 20-80%	5 hr
On-Board Connector Type	NEMA 6-20
Off-Board Charger #1	240V 1 Phase
Charging Time 0-100%	7.3 hr
Charging Time 20-80%	4.5 hr
Off-Board Charger #2	208V 3 Phase
Charging Time 0-100%	2.5 hr
Charging Time 20-80%	1.5 hr
Off-Board Charger #3	480V 3 Phase
Charging Time 0-100%	2 hr
Charging Time 20-80%	1 hr
Run Time	4-8 hours Depending on Application
Motor Type	Internal permanent magnet (IPM)
Rated motor power	34 hp (25kW)
Peak motor power	43 hp (32kW)
Motor Speed	
Eco Mode	2000 RPM
Standard Mode	2400 RPM
Power Mode	2600 RPM

TRACK DRIVE

Max Travel Speed	
Turtle	1.6 mph (2.6 kph)
Rabbit	2.5 mph (4.0 kph)
Traction Force	4,950 lbf (2 200 daN)
Gradeability	30° (60%)
Ground Pressure	5 psi (0.35 kg/cm2)

OPERATOR ENVIRONMENT

Tilttable Roll-bar (ROPS/TOPS); Optional canopy (FOPS Level 1); Vinyl seat; Height adjustable arm rests; Controls cut-out lever (safety lever); 2 in (51 mm) Seat belt; Bottle/cup holder; Keyed locks common w/ starting key; Document glove box; Slewing locking lever; Auxiliary electrical socket; Control Panel.

Controls:

Travel Levers; Travel foot pedals; EH joysticks for boom, arm, bucket, and swing; Emergency stop button; Boom swing roller switch; Horn; Auxiliary hydraulics roller; Ignition switch; Blade control lever.

Display includes:

Hydraulic Oil Temp; Machine hours; Time; Warning Indicators; Message area; Function Indicators; Work modes; Motor speed; Battery level indicator; Fast drive indicator; Equipment selection; Control mode.

OPERATING WEIGHT

Standard Arm & Canopy	5,159 lb (2 340 kg)
Standard Arm & Cab	5,445 lb (2 470 kg)
Long Arm & Roll Bar	5,180 lb (2 350 kg)
Long Arm & Canopy	5,467 lb (2 480 kg)
Mechanical quick coupler	68 lb (31 kg)

NOTE: Weight includes bucket, 165 lb operator, fluids, full fuel tank.

SERVICE CAPACITIES

Hydraulic tank:	
Refill capacity	3.8 gal (14.5 L)
Total system	7.4 gal (28 L)

HYDRAULICS

Load Sensing w/ "Flow Sharing" control valve	
Pump type	Load sense variable pump
Pump displacement	1.1 in ³ (18 cc)
Total flow rate	13.7 gpm (52 L/min)
Operating pressure	3,045 psi (210 bar)

Auxiliary flow:

Aux 1 – 1 or 2-way circuit:

Max Flow	13.2 gpm (50 L/min)
Max Pressure	3,190 psi (220 bar)

Aux 2 – 2-way circuit:

Max Flow	13.2 gpm (50 L/min)
Max Pressure	3,190 psi (220 bar)

Swing Motor:	Hydraulic drive units w/ axial pistons
--------------	--

Travel Motor:	Variable displacement hydraulic orbital gear motors, Auto-Shift 2-speed transmission, and hydraulic released parking brake
---------------	--

OTHER SPECIFICATIONS

Swing speed	10.5 RPM
Boom:	
Swing	81° left / 58° right
Length	6 ft 3 in (1.9 m)
Arm:	
Standard Length	4 ft 1 in (1.25 m)
Long arm length	4 ft 9 in (1.45 m)

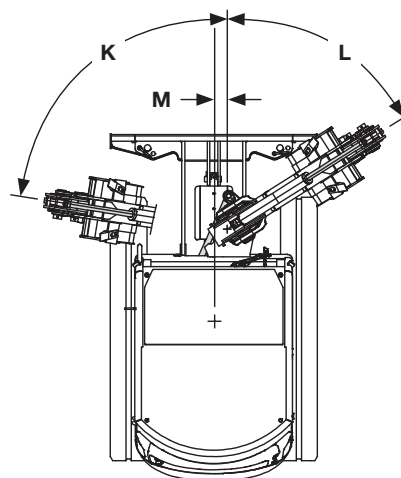
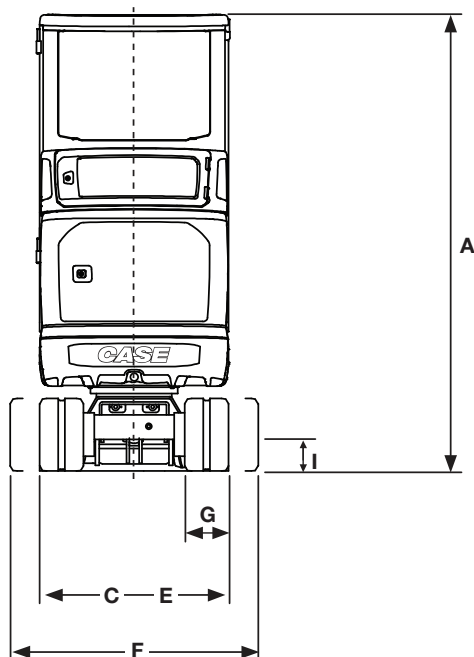

Line drawings are for illustrative purpose only and may not be exact representation of unit.

DIMENSIONS

A. Overall height	7 ft 10 in (2 395 mm)
B. Overall transport length	13 ft 7 in (4 145 mm)
C. Width of upper structure	3 ft 3 in (990 mm)
D. Track overall length	5 ft 5 in (1 655 mm)
Track overall width:	
E. Tracks Retracted	3 ft 3 in (990 mm)
F. Tracks Extended	4 ft 3 in (1 300 mm)
G. Track shoe width	9 in (230 mm)
H. Center to center – idler to sprocket	4 ft 2 in (1 280 mm)
I. Minimum ground clearance	6 in (165 mm)
J. Tail swing radius:	
Standard counterweight	3 ft 1 in (950 mm)
Tail swing overhang:	
Tracks retracted	1 ft 6 in (455 mm)
Tracks extended	12 in (300 mm)
K. Boom swing left	81°
L. Boom swing right	58°
M. Boom swing offset	3 in (80 mm)

BLADE SPECS

N. Backfill blade height	10 in (245 mm)
O. Backfill blade rise above ground	11 in (280 mm)
P. Backfill blade dig depth	11 in (275 mm)
Backfill blade width	3 ft 3 in (990 mm) - 4 ft 3 in (1 300 mm)

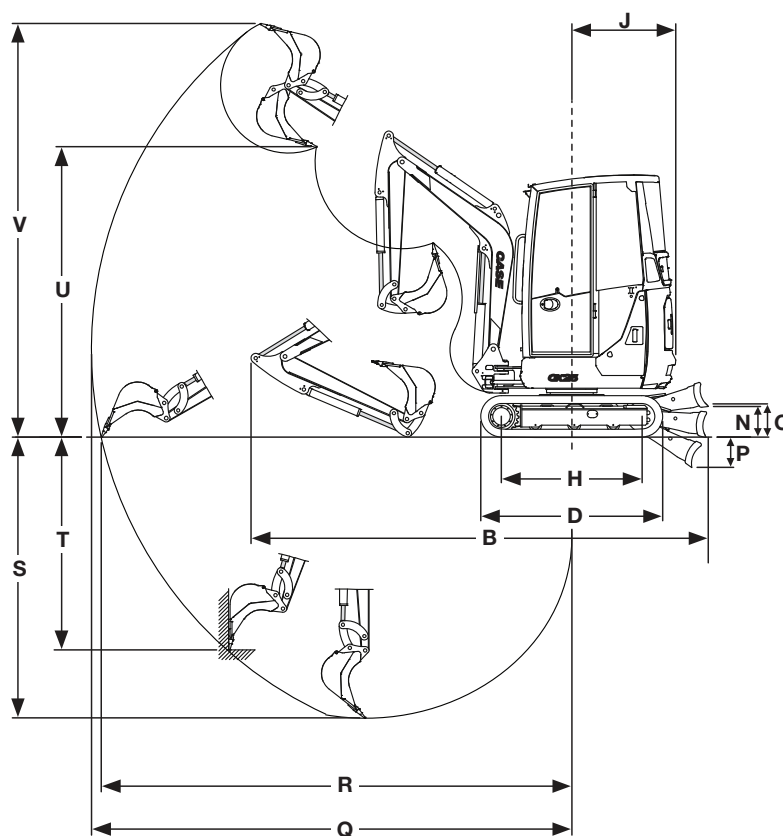

PERFORMANCE SPECS

	STANDARD ARM	LONG ARM
Arm Length	4 ft 1 in (1.25 m) Arm	4 ft 9 in (1.45 m) Arm
Q. Maximum dig radius	14 ft 4 in (4 380 mm)	15 ft 0 in (4 480 mm)
R. Dig radius at groundline	14 ft 1 in (4 290 mm)	14 ft 9 in (4 490 mm)
S. Maximum dig depth	8 ft 5 in (2 560 mm)	9 ft 1 in (2 760 mm)
T. Vertical straight wall dig depth	6 ft 5 in (1 950 mm)	7 ft 0 in (2 140 mm)
U. Dump height	8 ft 8 in (2 650 mm)	9 ft 1 in (2 760 mm)
V. Overall reach height	12 ft 5 in (3 775 mm)	12 ft 9 in (3 885 mm)
Arm digging force – ISO	2,248 lbf (1 000 daN)	
Bucket digging force – ISO	3,597 lbf (1 600 daN)	

LIFT CAPACITIES

6 ft 3 in (1.9 m) Boom, 4 ft 1 in (1.25 m) Arm Dozer Blade Up Machine equipped with cab, rubber tracks, standard counterweight, without bucket or quick coupler.

Load (Lift Point) Height	LOAD RADIUS										MAXIMUM REACH		
	4.9 ft (1.5 m)		6.6 ft (2.0 m)		8.2 ft (2.5 m)		9.8 ft (3.0 m)		11.5 ft (3.5 m)		REACH	CAPACITY	
	END	SIDE	END	SIDE	END	SIDE	END	SIDE	END	SIDE		END	SIDE
+8.2 ft (2.5 m)							794 lb (360 kg)*	794 lb (360 kg)*			10 ft 8 in (3.25 m)	860 lb (390 kg)*	794 lb (360 kg)
+6.6 ft (2.0 m)							816 lb (370 kg)*	816 lb (370 kg)*	838 lb (380 kg)	706 lb (320 kg)	11 ft 7 in (3.52 m)	816 lb (370 kg)	706 lb (320 kg)
+4.9 ft (1.5 m)					992 lb (450 kg)*	992 lb (450 kg)*	904 lb (410 kg)*	882 lb (400 kg)	816 lb (370 kg)	706 lb (320 kg)	12 ft 1 in (3.68 m)	772 lb (350 kg)	639 lb (290 kg)
+3.3 ft (1.0 m)			1,632 lb (740 kg)*	1,521 lb (690 kg)	1,213 lb (550 kg)*	1,103 lb (500 kg)	1,014 lb (460 kg)	860 lb (390 kg)	816 lb (370 kg)	684 lb (310 kg)	12 ft 4 in (3.76 m)	728 lb (330 kg)	617 lb (280 kg)
+1.6 ft (0.5 m)			1,786 lb (810 kg)	1,455 lb (660 kg)	1,301 lb (590 kg)	1,080 lb (490 kg)	992 lb (450 kg)	838 lb (380 kg)	794 lb (360 kg)	684 lb (310 kg)	12 ft 4 in (3.75 m)	728 lb (330 kg)	617 lb (280 kg)
Groundline	2,778 lb (1,260 kg)	2,183 lb (990 kg)	1,742 lb (790 kg)	1,433 lb (650 kg)	1,257 lb (570 kg)	1,058 lb (480 kg)	992 lb (450 kg)	816 lb (370 kg)	794 lb (360 kg)	662 lb (300 kg)	12 ft 0 in (3.66 m)	750 lb (340 kg)	639 lb (290 kg)
-1.6 ft (-0.5 m)	2,778 lb (1,260 kg)	2,183 lb (990 kg)	1,742 lb (790 kg)	1,411 lb (640 kg)	1,257 lb (570 kg)	1,036 lb (470 kg)	970 lb (440 kg)	816 lb (370 kg)			11 ft 5 in (3.48 m)	794 lb (360 kg)	684 lb (310 kg)
-3.3 ft (-1.0 m)	2,800 lb (1,270 kg)	2,205 lb (1,000 kg)	1,742 lb (790 kg)	1,411 lb (640 kg)	1,257 lb (570 kg)	1,036 lb (470 kg)	970 lb (440 kg)	816 lb (370 kg)			10 ft 6 in (3.19 m)	904 lb (410 kg)	750 lb (340 kg)
-4.9 ft (-1.5 m)	2,514 lb (1,140 kg)*	2,227 lb (1,010 kg)	1,720 lb (780 kg)*	1,433 lb (650 kg)	1,235 lb (560 kg)*	1,058 lb (480 kg)					8 ft 11 in (2.73 m)	1,014 lb (460 kg)*	948 lb (430 kg)

6 ft 3 in (1.9 m) Boom, 4 ft 9 in (1.45 m) Long Arm Dozer Blade Up Machine equipped with cab, rubber tracks, standard counterweight, without bucket or quick coupler.

Load (Lift Point) Height	LOAD RADIUS										MAXIMUM REACH		
	4.9 ft (1.5 m)		6.6 ft (2.0 m)		8.2 ft (2.5 m)		9.8 ft (3.0 m)		11.5 ft (3.5 m)		REACH	CAPACITY	
	END	SIDE	END	SIDE	END	SIDE	END	SIDE	END	SIDE		@	END
+8.2 ft (2.5 m)							684 lb (310 kg)*	684 lb (310 kg)*			11 ft 5 in (3.49 m)	772 lb (350 kg)*	706 lb (320 kg)
+6.6 ft (2.0 m)							728 lb (330 kg)*	728 lb (330 kg)*	750 lb (340 kg)*	706 lb (320 kg)	12 ft 3 in (3.74 m)	750 lb (340 kg)	639 lb (290 kg)
+4.9 ft (1.5 m)							816 lb (370 kg)*	816 lb (370 kg)*	794 lb (360 kg)*	706 lb (320 kg)	12 ft 9 in (3.89 m)	706 lb (320 kg)	595 lb (270 kg)
+3.3 ft (1.0 m)			1,411 lb (640 kg)*	1,411 lb (640 kg)*	1,103 lb (500 kg)*	1,103 lb (500 kg)*	948 lb (430 kg)*	860 lb (390 kg)	816 lb (370 kg)	684 lb (310 kg)	13 ft 0 in (3.97 m)	684 lb (310 kg)	573 lb (260 kg)
+1.6 ft (0.5 m)			1,786 lb (810 kg)	1,477 lb (670 kg)	1,301 lb (590 kg)	1,080 lb (490 kg)	992 lb (450 kg)	838 lb (380 kg)	794 lb (360 kg)	684 lb (310 kg)	13 ft 0 in (3.97 m)	662 lb (300 kg)	573 lb (260 kg)
Groundline	2,778 lb (1,260 kg)	2,161 lb (980 kg)	1,742 lb (790 kg)	1,411 lb (640 kg)	1,257 lb (570 kg)	1,036 lb (470 kg)	970 lb (440 kg)	816 lb (370 kg)	794 lb (360 kg)	662 lb (300 kg)	12 ft 8 in (3.87 m)	684 lb (310 kg)	573 lb (260 kg)
-1.6 ft (-0.5 m)	2,756 lb (1,250 kg)	2,161 lb (980 kg)	1,720 lb (780 kg)	1,411 lb (640 kg)	1,235 lb (560 kg)	1,036 lb (470 kg)	970 lb (440 kg)	816 lb (370 kg)	794 lb (360 kg)	662 lb (300 kg)	12 ft 2 in (3.71 m)	728 lb (330 kg)	617 lb (280 kg)
-3.3 ft (-1.0 m)	2,778 lb (1,260 kg)	2,161 lb (980 kg)	1,720 lb (780 kg)	1,389 lb (630 kg)	1,235 lb (560 kg)	1,014 lb (460 kg)	970 lb (440 kg)	794 lb (360 kg)			11 ft 3 in (3.44 m)	816 lb (370 kg)	684 lb (310 kg)
-4.9 ft (-1.5 m)	2,800 lb (1,270 kg)	2,183 lb (990 kg)	1,742 lb (790 kg)	1,411 lb (640 kg)	1,235 lb (560 kg)	1,036 lb (470 kg)	970 lb (440 kg)*	816 lb (370 kg)			9 ft 11 in (3.03 m)	948 lb (430 kg)*	816 lb (370 kg)

NOTE: Lifting capacity are based on ISO 10567.

Lifting capacity does not exceed 75% of tipping load with the machine on firm, level ground or 87% of full hydraulic capacity.

Back of the arm linkage.

*Indicates load limited by hydraulic capacity.

For lift capacities with additional counterweights please see operators manual.

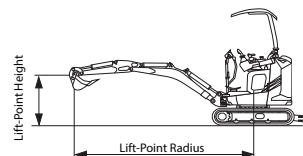

STANDARD EQUIPMENT

ELECTRICAL

12-volt electrical system
Heavy-duty battery
Electronic display and controls
3 pre-set Control modes
Electronic flow setting for every mode and auxiliary circuits
On-board battery charger (240 VAC)
Control pattern mode
Auxiliary electrical socket

HYDRAULICS

Joysticks with Electro-Hydraulic proportional controls
Electro-Hydraulic proportional swing control
1st Auxiliary (AUX1) circuit with Electro-Hydraulic proportional control
Boom Lift cylinder and dozer blade cylinder protection
Helical Gear Pump
Bio-degradable hydraulic oil and lubricants

TRACK DRIVE

Rubber belt tracks
2-speed travel with Automatic Shift Down (from 2nd to 1st gear if more traction is required) and Shift Up
Fully hydrostatic drive system
Sealed and lubricated track rollers
Track tensioner hydraulic adjustment with grease

OPERATOR ENVIRONMENT

Open ROPS (Level 1)
Vinyl mechanical suspension seat
2" lap seat belt

LIGHTING

Standard LED working lights (boom)

UPPER STRUCTURE

Standard arm: 4 ft 1 in (1.25 m)
Swing brake disc type, spring applied and hydraulically released
Standard dozer blade

OTHER

Swing boom – 81° left/58° right
Standard counterweight
Extendable undercarriage
Operator manual
Document box and Tool kit for maintenance
Travel alarm

TELEMATICS

CASE SiteWatch™ Telematics – includes hardware and a 5-yr Advanced data subscription for 2-way communication

WARRANTY

Base warranty coverage: 2-Year/2,000-Hour Full Machine Limited Warranty
3 Year Electric Powertrain Warranty – (includes all electric powertrain system components - battery, motors, inverters, etc.)

OPTIONAL EQUIPMENT

ELECTRICAL

Offboard Fast-Charger

HYDRAULICS

2nd Auxiliary (AUX2) circuit with Electro-Hydraulic proportional control
Attachment case drain return to tank
Hydraulic quick coupler provision
Object handling boom and arm hose burst check valves

OPERATOR ENVIRONMENT

Enclosed cab includes overhead opening front window, sliding side window, lockable door, heater and defroster, radio/USB player + 2 speakers
Cloth mechanical suspension seat

LIGHTING

Extra LED working lights (roof)
LED beacon

OTHER

Long arm: 4 ft 9 in (1.45 m)
English, Spanish, or French Operator Manual

ATTACHMENTS

Mechanical quick coupler
Hydraulic coupler
Digging buckets

CaseCE.com

©2025 CNH Industrial America LLC. All rights reserved. CASE is a trademark registered in the United States and many other countries, owned by or licensed to CNH Industrial N.V., its subsidiaries or affiliates. CNH Industrial Capital is a trademark in the United States and many other countries, owned by or licensed to CNH Industrial N.V., its subsidiaries or affiliates.

IMPORTANT: CASE Construction Equipment Inc. reserves the right to change these specifications without notice and without incurring any obligation relating to such change. Availability of some models and equipment builds vary according to the country in which the equipment is used. The illustrations and text may include optional equipment and accessories and may not include all standard equipment. Your CASE dealer/distributor will be able to give you details of the products and their specifications available in your area.



Always read the Operator's Manual before operating any equipment. Inspect equipment before using it, and be sure it is operating properly. Follow the product safety signs and use any safety features provided.