

C314 - MINI TRACK LOADER



**POWERFULLY COMPACT
MACHINES**



TAKE A BREAK FROM BACK-BREAKING WORK.

The **New Holland C314 Mini Track Loader** delivers all the power and performance you need to get more done faster. Its impressive operating capacity lets you tackle a wider range of residential construction and landscaping tasks, while the compact width makes it easy to maneuver in tight spaces.

Power and versatility are a formidable combination in a C314:

- **1,000 lbs. of rated operating capacity** easily handles lift-and-carry operations
- **Common industry interface and 14-pin electric multifunction control** (OPTIONAL) offers greater versatility with new and older attachments
- **Wide range of attachments** power New Holland augers, trenchers, grapple buckets, rakes, and more



OPERATING WEIGHT

Narrow Track (NT)	2X Counterweights (STD): 3,536 lb (1 604 kg)
Wide Track (WT)	6X Counterweight (OPT): 3,783 lb (1 716 kg)

DIMENSIONS

Overall Height	56.5 in (1 435 mm)
Overall Length: Without Bucket	85.6 in (2 175 mm)
Machine Width:	
Narrow Track	35.0 in (890 mm)
Wide Track	40.4 in (1 026 mm)
Bucket Width:	
Narrow Track	36.0 in (914 mm)
Wide Track	42.0 in (1 067 mm)

LOADER PERFORMANCE SPECS

Lift Geometry	Radial Lift
Narrow Track Rated operating capacity – ROC*:	
35% of tipping load	992 lb (450 kg)
50% of tipping load	1,416 lb (643 kg)
Narrow Track Tipping load*	2,833 lb (1 285 kg)
Wide Track Rated operating capacity – ROC*:	
35% of tipping load	1,102 lb (500 kg)
50% of tipping load	1,574 lb (714 kg)
Wide Track Tipping load*	3,148 lb (1 428 kg)

NOTE: *Measured using standard equip bucket.

ENGINE

Model	Kubota DI305-E4B
Emissions Certification	Stage V
Cylinders	3
Displacement	77.0 in ³ (1.261 L)
Fuel	Diesel
Exhaust aftertreatment	N/A
Engine speeds Rated – full load	RPM 2600
Horsepower @ 2600 RPM – SAE J1349:	
Gross Net	24.8 hp (18.5 kW) 24 hp (18.0 kW)
Peak torque @ 1700 RPM	59.1 lb ft (80.1 N m)

DRIVETRAIN

Transmission Type	Hydrostatic
Max. Travel speed	4.7 mph (7.5 kph)
Parking brake: Type	SAHR pin brake

ELECTRICAL

System Voltage	12 Volts
Alternator	60 amp
Battery	62 AHR 540 cold-cranking amps @ 0° F (-18° C)

HYDRAULICS

Implement pump type	Fixed Gear
Displacement	1.2 in ³ (19 cm ³)
Standard flow @ rated engine RPM: @ 100% efficiency	13.2 gpm (50 L/min)
Loader control valve: Type	Open center
Implement Hydraulics Operating Pressure:	2,800 psi (190 bar)

SERVICE CAPACITIES

Fuel Tank	7.9 gal (30 L)
Engine oil w/ filter	6.0 qt (5.7 L)
Hydraulic system	4.5 gal (17 L)
Engine Coolant	0.9 gal (3.5 L)



TRACK SELECTION

Type	Area	Ground Pressure	Width to Outside Track
7 in (180 mm) – Narrow Track	594 in ² (0.38 m ²)	5.9 psi (0.41 kg/cm ²)	35.0 in (890 mm)
10 in (250 mm) – Wide Track	825 in ² (0.53 m ²)	4.6 psi (0.32 kg/cm ²)	40.4 in (1 026 mm)

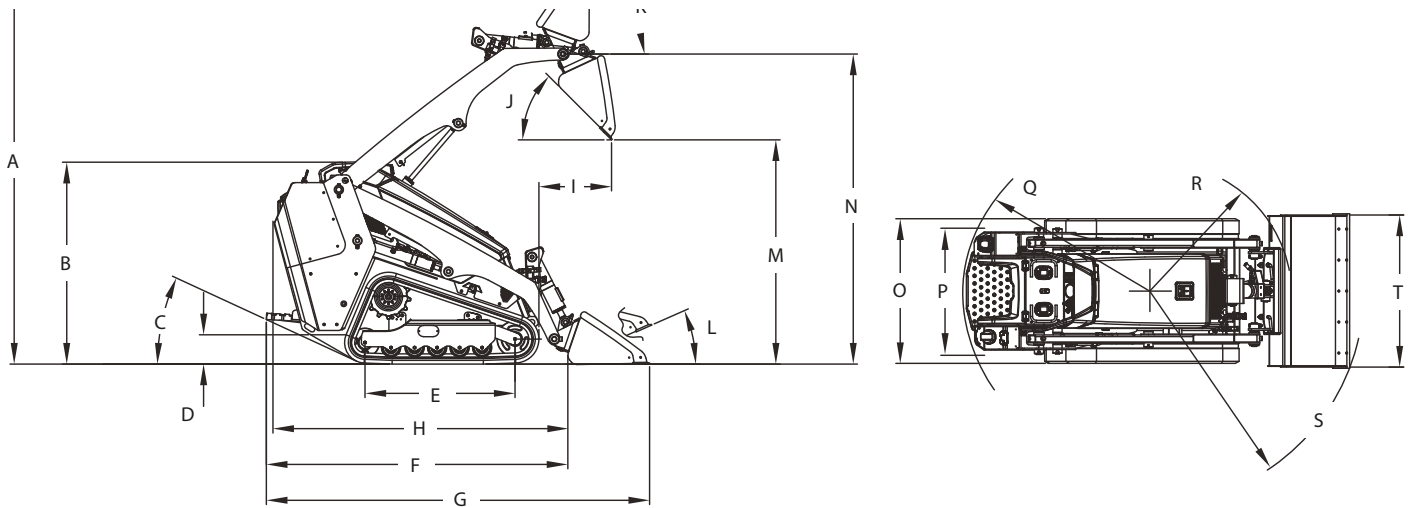

Line drawings are for illustrative purpose only and may not be exact representation of unit.

DIMENSIONS		
A	Overall operating height	114.6 in (2 911 mm)
B	Overall height	56.5 in (1 435 mm)
C	Rear departure angle	31°
D	Ground clearance	8.7 in (222 mm)
E	Track length on ground	41.9 in (1 065 mm)
Overall length:		
F	without bucket	85.6 in (2 175 mm)
G	with standard bucket	110.1 in (2 796 mm)
H	Transport Length – no bucket, platform raised	85.0 in (2 155 mm)
I	Reach at Maximum Dump	22.0 in (570 mm)
J	Dump angle	42°
K	Maximum rollback at full height	90°
L	Maximum rollback at ground	24°
M	Dump height – standard bucket	62.0 in (1 580 mm)
N	Hinge Pin Height	86.7 in (2 201 mm)
Machine width:		
O	Narrow Track	35.0 in (890 mm)
	Wide Track	40.4 in (1 026 mm)
Track Gauge:		
P	Narrow Track	28.0 in (710 mm)
	Wide Track	30.6 in (776 mm)
Clearance Circle Radius:		
Q	Rear	53.1 in (1 348 mm)
R	No bucket	35.9 in (913 mm)
S	Standard bucket	60.7 in (1 541 mm)
Bucket Width:		
T	Narrow Track	36.0 in (914 mm)
	Wide Track	42.0 in (1 067 mm)

STANDARD EQUIPMENT

Operator Environment

- Hydraulic pilot joystick control
- Loader and ground drive control lockout
- Cushioned operator platform
- Operator grab handles
- Key start
- Hand throttle
- Cup holder
- Pocket for cellular phone.
- Operator presence sensor

Engine

- Engine tip-over shut-off
- Glow plug starting aid
- Locking fuel cap
- Fuel filter with water separator
- Electric fuel pump

Drivetrain

- Dual hydrostatic drive motors
- SAHR parking brake
- 5 roller undercarriage
- Narrow rubber track belt

Hydraulics

- 3-spool loader control valve
- 1x dual acting auxiliary hydraulics
- Proportional auxiliary hydraulic control on joystick with detent
- Loader arm float

Loader

- Radial lift geometry
- CII mech attachment coupler
- Loader lift arm support strut
- 2x additional counterweight

Electrical

- 12V power plug socket
- Front and rear LED work lights
- Master battery disconnect

Other Standard Features

- Lock-able hood compartment
- Horn

Warranty

- Base warranty coverage: 2-Year/2,000-hour full machine limited warranty (Warranty terms can vary according to local markets' agreement.)

OPTIONAL EQUIPMENT

Drivetrain

- Wide rubber track belt

Hydraulics

- Case drain attachment connection
- Bio-hydraulic oil and lubricants

Electrical

- 14-pin electrical auxiliary connection

Loader

- 36 in dirt bucket
- 42 in dirt bucket
- Bolt on bucket teeth
- Bolt on bucket cutting edge
- 6x additional counterweights

Telematics

- FleetForce™ Telematics includes hardware and a 5-year advanced subscription

Other

- English, Spanish, or French Operator Manual



The New Holland dealer network is, in itself, the best guarantee of continued productivity for the machines it delivers to its customers. New Holland service technicians are fully equipped to resolve all maintenance and repair issues, with each and every service point providing the high standards of New Holland's stringent quality guidelines. The New Holland global parts network ensures fast, reliable, replacement parts for less downtime, increased productivity and, of course, profitable operation for its customers.

Learn more at www.newholland.com

Printed on recycled paper
CoC-FSC 000010 CQ Mixed sources



AT YOUR OWN DEALERSHIP

The information contained in this brochure is intended to be of general nature only. The NEW HOLLAND CONSTRUCTION MACHINERY S.p.A. company may at any time and from time to time, for technical or other necessary reasons, modify any of the details or specifications of the product described in this brochure. Illustrations do not necessarily show products in standard conditions. The dimensions, weights and capacities shown herein, as well as any conversion data used, are approximate only and are subject to variations within normal manufacturing techniques.