



OPERATING WEIGHT

Narrow Track (NT) - 2 x Counterweights (STD):	3,886 lb (1 862 kg)
Wide Track (WT) - 6 x Counterweight (OPT):	4,133 lb (1 875 kg)

OVERALL DIMENSIONS

Overall Height	56.5 in (1 435 mm)
Overall Length: Without Bucket	85.6 in (2 175 mm)
Machine Width:	
Narrow Track	35 in (890 mm)
Wide Track	40.4 in (1 026 mm)
Bucket Width:	
Narrow Track	36 in (914 mm)
Wide Track	42 in (1 067 mm)

SERVICE CAPACITIES

Hydraulic system	6.7 gal (25.3 L)
------------------	------------------

ELECTRIC POWERTRAIN

Nominal Battery Voltage	102 Volts
Battery Chemistry	Lithium Ion
Battery Capacity:	
Total Gross Capacity	23.5 kWh
Net Usable Capacity	21.2 kWh
Connector Type SAE J1772 Type 1:	240 Volts
Charging Time 0 - 100%	8 hr
Charging Time 20 - 80%	5 hr
Off Board Charger #1 240V	1 Phase
Charging Time 0 - 100%	6 hr
Charging Time 20 - 80%	3.5 hr
Off Board Charger #2 208V	3 Phase
Charging Time 0 - 100%	3 hr
Charging Time 20 - 80%	2 hr
Off Board Charger #3 480V	3 Phase
Charging Time 0 - 100%	2.2 hr
Charging Time 20 - 80%	1.5 hr
Run Time:	3 - 7 hours depending on application
Motor Type	Internal permanent Magnet
Motor Power	33.5 hp (25kW)
Motor Speed	
Power Mode	2,800 rpm
Standard Mode	2,600 rpm
ECO Mode	2,400 rpm
Traction Motors (2 total):	
Rated power	11.3 hp (8.4 kW)
Peak power	23.1 hp (17.2 kW)
Rated torque	20.4 ft. lb (27.6 Nm)
Peak torque	35.4 ft. lb (48 Nm)
Implement Motor:	
Rated power	33.5 hp (25 kW)
Peak power	42.9 hp (32 kW)
Rated torque	63.4 ft. lb (86 Nm)
Peak torque	92.2 ft. lb (125 Nm)

DRIVETRAIN

Track Motor Type:	
Nominal Power	14.2 hp (10.6 kW) - 2 x
Nominal Torque	16.6 lbf (22.5 Nm) - 2 x
Max Travel Speed:	
Turtle	5 mph (8 kph)
Rabbit	2.5 mph (4 kph)
Regenerative electric service brake	
Negative mechanical parking brake with spring on discs	

LOADER PERFORMANCE SPECS

Lift Geometry	Radial Lift
Narrow Track Rated operating capacity - ROC*:	
35% of tipping load	989 lb (449 kg)
50% of tipping load	1,405 lb (637 kg)
Narrow Track Tipping load*	2,810 lb (1 275 kg)
Wide Track Rated operating capacity - ROC*:	
35% of tipping load	1,034 lb (469 kg)
50% of tipping load	1,472 lb (667 kg)
Wide Track Tipping load*	2,945 lb (1 336 kg)

NOTE: *Measured using standard equip bucket.

HYDRAULICS

Implement pump type	Fixed Gear
Displacement	1.2 in ³ (20 cm ³)
Standard flow @ rated engine RPM:	
@ 100% efficiency	13.7 gpm (52 L/min)
Loader control valve:	
Type	Open center
Implement Hydraulics Operating Pressure:	2,800 psi (190 bar)

DIMENSIONS

A. Overall operating height	114.6 in (2 911 mm)
B. Overall height	56.5 in (1 435 mm)
C. Rear departure angle	24°
D. Ground clearance	8.7 in (222 mm)
E. Track length on ground	41.9 in (1 065 mm)
Overall length:	
F. Without bucket	85.6 in (2 175 mm)
G. With standard bucket	110.1 in (2 796 mm)
H. Transport Length – no bucket, platform raised:	85 in (2 155 mm)
I. Reach at Maximum Dump	22.24 in (570 mm)
J. Dump angle	42°
K. Maximum rollback at full height	90°
L. Maximum rollback at ground	24°
M. Dump height – standard bucket	61 in (1 549 mm)
N. Hinge Pin Height	86.6 in (2 200 mm)
O. Machine Width:	
Narrow Track	35 in (890 mm)
Wide Track	40.4 in (1 026 mm)
P. Track Gauge:	
Narrow Track	28 in (710 mm)
Wide Track	30.6 in (776 mm)
Clearance Circle Radius:	
Q. Rear	53.1 in (1 348 mm)
R. No bucket	35.9 in (913 mm)
S. Standard bucket	60.7 in (1 541 mm)
T. Bucket Width:	
Narrow Track	36 in (914 mm)
Wide Track	42 in (1 067 mm)

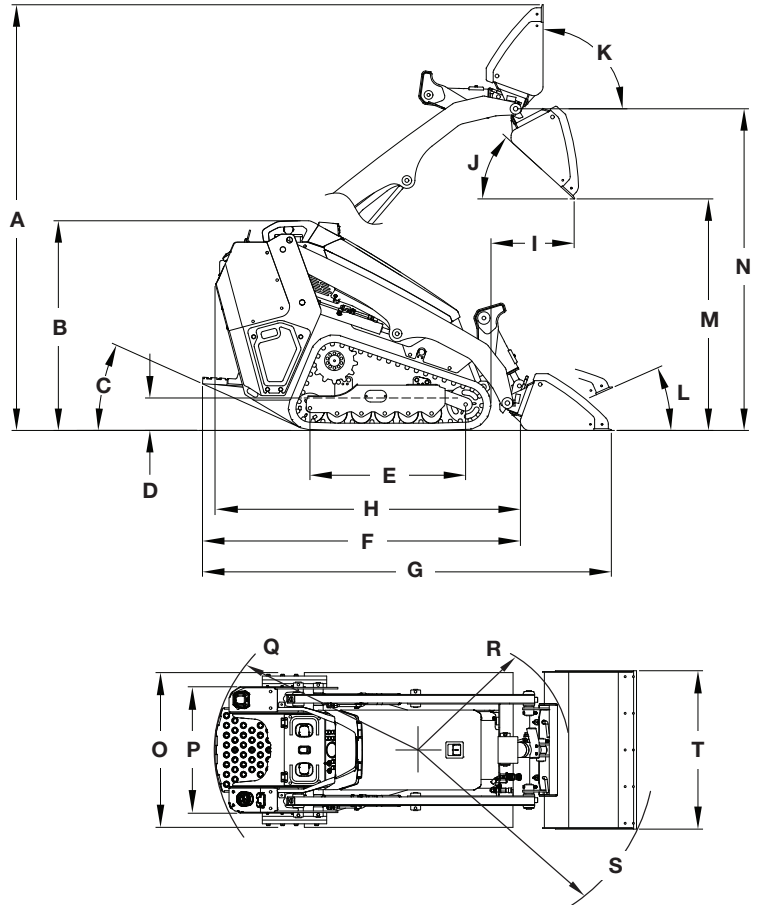

Line drawings are for illustrative purpose only and may not be exact representation of unit.

TRACK SELECTION

Type	Area	Ground Pressure	Width to Outside Track
7 in (180 mm) – Narrow Track*	594 in ² (0.38 m ²)	5.8 psi (0.41 kg/cm ²)	35.0 in (890 mm)
10 in (250 mm) – Wide Track*	825 in ² (0.53 m ²)	4.4 psi (0.31 kg/cm ²)	40.4 in (1 026 mm)

NOTE: *Non-marring track option available

STANDARD EQUIPMENT

OPERATOR ENVIRONMENT

- Electro-Hydraulic Joystick Controls
- Loader and ground drive control lockout
- Cushioned operator platform
- Operator presence sensor
- Operator grab handles
- Key start
- Cup holder
- Pocket for cellular phone

BATTERY

- Lockable hood compartment
- Charging cord storage compartment

DRIVETRAIN

- Dual electric drive motors
- SAHR parking brake
- 5 roller undercarriage
- Wide rubber track belt

HYDRAULICS

- Case drain attachment connection
- 3-spool loader control valve
- 1 × dual acting auxiliary hydraulics
- Proportional auxiliary hydraulic control on joystick with detent
- Electro-Hydraulic 1-way/2-way auxiliary hydraulic selector
- Loader arm float
- Bio-Hydraulic oil and lubricants

LOADER

- Radial lift geometry
- CII mechanical attachment coupler
- Loader lift arm support strut
- 6 × counterweights

ELECTRICAL

- 14-pin electrical auxiliary connection
- 12V power plug socket
- Front and rear LED work lights
- Master battery disconnect
- Horn

WARRANTY

- Base warranty coverage: 2-Year/2,000-Hour Full Machine Limited Warranty
- 3-Year/3,000-Hour electrical components Limited Liability Warranty

TELEMATICS

- MyCASEConstruction Telematics - Includes hardware and 7-yr data subscription

OPTIONAL EQUIPMENT

DRIVETRAIN

- Narrow rubber track belt
- Narrow and wide non-marring tracks

LOADER

- 36 in dirt bucket
- 42 in dirt bucket
- Bolt on bucket teeth
- Bolt on bucket cutting edge
- 2 × counterweights

ELECTRICAL

- Strobe Light
- 2 × additional boom mounted lights

OTHER

- English, Spanish or French Operator's Manual

CaseCE.com

©2026 CNH Industrial America LLC. All rights reserved. CASE is a trademark registered in the United States and many other countries, owned by or licensed to CNH Industrial N.V., its subsidiaries or affiliates. CNH Industrial Capital is a trademark in the United States and many other countries, owned by or licensed to CNH Industrial N.V., its subsidiaries or affiliates. Printed in U.S.A. Contains 10% post-consumer fiber.

IMPORTANT: CASE Construction Equipment Inc. reserves the right to change these specifications without notice and without incurring any obligation relating to such change. Availability of some models and equipment builds vary according to the country in which the equipment is used. The illustrations and text may include optional equipment and accessories and may not include all standard equipment. Your CASE dealer/distributor will be able to give you details of the products and their specifications available in your area.



Always read the Operator's Manual before operating any equipment. Inspect equipment before using it, and be sure it is operating properly. Follow the product safety signs and use any safety features provided.

Form No. CCE202606TL100EV
Replaces Form No. CCE202601TL100EV

TL100EV

3 of 3