

ML15

SMALL ARTICULATED LOADER



OPERATING WEIGHT	
Open cab	3,362 lb. (1525 kg)

OVERALL DIMENSIONS	
Overall height	87.8 in. (2230 mm)
Overall length:	
Without bucket	107.0 in. (2718 mm)
Machine width	43.3 in. (1100 mm)

LOADER PERFORMANCE SPECS	
Lifting height	81.4 in. (2067 mm)
Tipping load (ISO) – Straight	3,307 lb. (1500 kg)
Lifting capacity	3,086 lb. (1400 kg)

ELECTRICAL	
System voltage	12 volts
Alternator	60 amp
Battery	52 AHR 520 cold-cranking amps

ENGINE	
Model	Kubota D1105
Emissions certification	Tier 4 Final Certified
Cylinders	3
Displacement	68.5 in. ³ (1.123 L)
Fuel	Diesel
Exhaust aftertreatment	—
Engine speeds	RPM
Rated – full load	3,000
Horsepower @ 3,000 RPM – SAE J1349:	
Gross	26 hp (19.4 kW)
Peak torque @ 2,200 RPM	52.7 lb-ft (71.5 N·m)

DRIVETRAIN	
Transmission type	Hydrostatic
Differential type	Hydraulic controlled
Parking brake:	Hydraulic multidisk
Type	brake
Max. travel speed	11.8 mph (19 kph)

— Not available.

HYDRAULICS	
Control valve type	Open center
Pump type	Fixed gear
Driving hydraulics:	
Flow rate	22.2 gpm (84 L/min)
Operating pressure	5,100 psi (350 bar)
Working Hydraulics:	
Total flow rate	11.1 gpm (42 L/min)
Operating pressure	2,500 psi (170 bar)
Auxiliary 1:	
Max. flow rate	11.1 gpm (42 L/min)
Pressure	2,500 psi (170 bar)
Auxiliary 2 — optional:	
Max. flow rate	11.1 gpm (42 L/min)
Pressure	2,500 psi (170 bar)
Continuous flow — optional:	
Max. flow rate	8.7 gpm (33 L/min)
Pressure	2,500 psi (170 bar)

SERVICE CAPACITIES	
Fuel tank	5.5 gal. (21 L)
Engine oil w/ filter	4.6 qt. (4.4 L)
Hydraulic system	12.2 gal. (46 L)
Engine coolant	1.1 gal. (4.4 L)

Standard Equipment

Operator Environment

- ROPS/FOPS safety roof
- Safety entry bar
- Key start
- Non-suspension vinyl seat
- Armrests
- Retractable seat belt
- Exterior mirrors

Engine

- Glow plug starting aid
- Engine block heater
- Locking fuel cap

Drivetrain

- Hydrostatic 4-wheel drive
- FNR control on joystick
- Electro-hydraulic controlled, manually activated differential
- Hydraulic parking brake

Hydraulics

- 3-spool main control valve
- 1x dual acting auxiliary hydraulics
- Attachment case drain return
- Loader arm float
- Oil cooler

Loader

- Standard lift path
- Mechanical self leveling
- Loader lift arm support strut
- CII mechanical attachment coupler
- Additional counterweights

Electrical

- 12 volt system
- 52 AHR, 520 CCA battery
- 60 A alternator
- 2 front cab work lights
- Remote jumpstart provision

Other Standard Features

- Tow coupling
- Lifting eyes
- Backup alarm
- Horn

Warranty

- Base warranty coverage: 2-Year/1,000-Hour Full Machine Limited Warranty

Optional Equipment

Operator Environment

- Fold-able open ROPS
- Enclosed cab with heat

Engine

- Hand throttle

Drivetrain

- Oscillation lock-out

Hydraulics

- 2x dual acting auxiliary hydraulics
- Auxiliary hydraulic hold function
- Continuous flow auxiliary hydraulics
- Hydraulic boom suspension (ride control)

Electrical

- 1 boom worklight
- 2 cab rear work lights
- 3-pin electrical auxiliary connection
- Rotating beacon light
- Strobe light

Other

- English, Spanish, or French operator manual

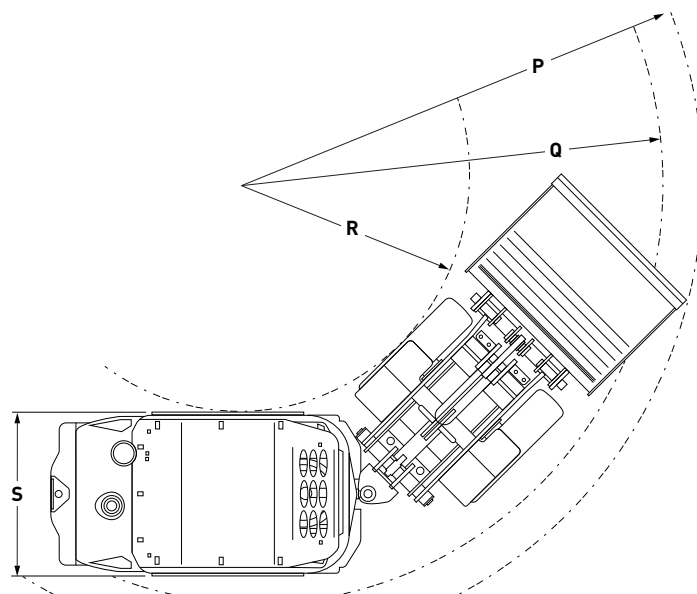
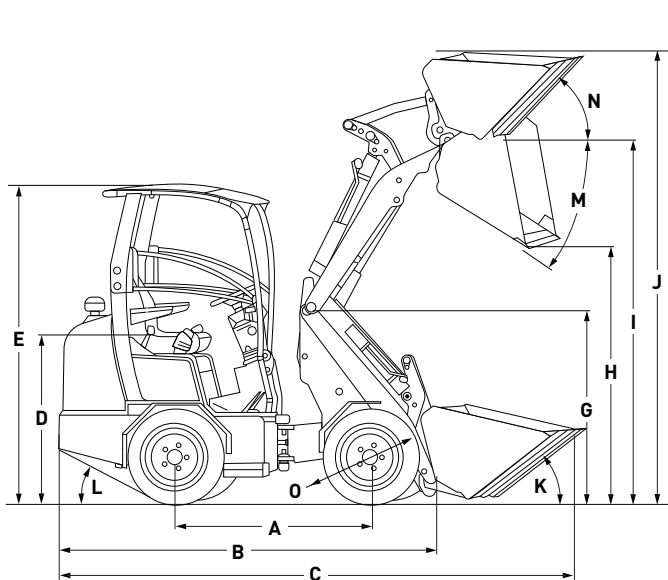

DIMENSIONS

A	Wheelbase	55.9 in. [1419 mm]
B	Total length	107.0 in. [2718 mm]
C	Length with bucket	133.4 in. [3389 mm]
D	Seat height	44.7 in. [1136 mm]
E	Max. height with safety roof	87.8 in. [2230 mm]
F	Max. height with cabin	87.8 in. [2230 mm]
G	Height front frame	45.2 in. [1148 mm]
H	Max. dumping height	53.5 in. [1360 mm]
I	Lifting height	81.4 in. [2067 mm]
J	Height with bucket	104.0 in. [2641 mm]
K	Rollback angle on the ground	44°
L	Rollback angle at max. lift height	55°
M	Max. dumping angle	41°
N	Max. loading angle	27°
O	Outer size of tires	26.4 in. [670 mm]
P	Maximum radius external	97.2 in. [2469 mm]
Q	Turning radius on outer edge	89.1 in. [2263 mm]
R	Inner turning radius	45.8 in. [1163 mm]
S	Width on standard tires	43.3 in. [1100 mm]

TIPPING LOADS

T	3,310 lb. (1500 kg)
U	2,430 lb. (1100 kg)
V	1,650 lb. (750 kg)
W	1,210 lb. (550 kg)
X	3,310 lb. (1500 kg)
Y	1,980 lb. (900 kg)
Z	1,430 lb. (650 kg)

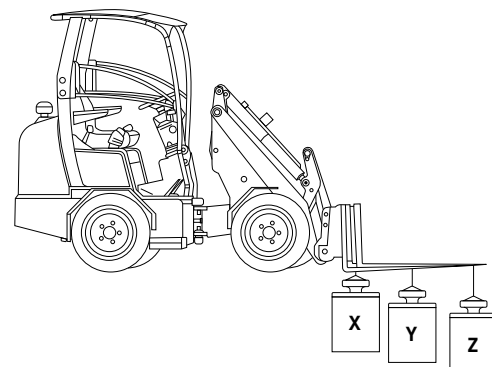
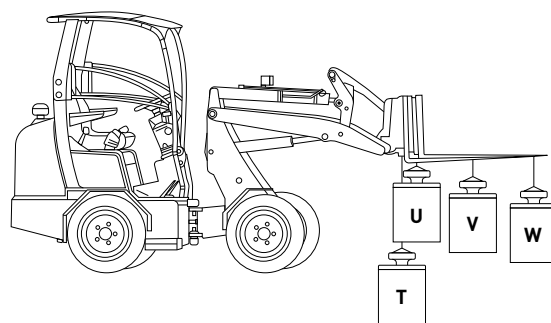

Line drawings are for illustrative purpose only and may not be exact representation of unit.



New Holland Construction
500 Diller Ave.
New Holland, PA 17557

Learn more at www.newholland.com

Design, materials and/or specifications are subject to change without notice and without liability therefor. Specifications are applicable to units sold in Canada, the United States, its territories and possessions, and may vary outside these areas.

© 2023 CNH Industrial America LLC. All rights reserved. New Holland is a trademark registered in the United States and many other countries, owned by or licensed to CNH Industrial N.V., its subsidiaries or affiliates. Any trademarks referred to herein, in association with goods and/or services of companies, other than owned by or licensed to CNH Industrial N.V., its subsidiaries or affiliates, are the property of those respective companies.



Safety begins with a thorough understanding of the equipment. Always make sure you and your operators read the Operator's Manual before using the equipment. Pay close attention to all safety and operating decals and never operate machinery without all shields, protective devices and structures in place.

NHC7130238303 • 0923 • OTP • PRINTED IN U.S.A.

